

AC SERIES

Air Cargo Casters



Applications

- Cargo Conveyor Equipment

Features

- Fully Sealed Raceways
- Precision Bearing Swivel Raceway
- Yellow ZC Dichromate Finish
- Thread Guards Standard on Wheels

Options

- Special Top Plates Available
- Toe Guards Available
- Additional Wheel Colors Available

AC - Air Cargo Casters

Wheel Dia.	Tread Width (in.)	Tread Material	Tread Color	Wheel Bearing	Axle Size	Load Rating (lbs.)	Overall Height (in.)	Swivel Radius	Mounting Bolt Dia.	Swivel Caster Description	Order No.	Top Plate
2 5/8	1 3/8	Polypropylene	Tan	Needle	3/8	375	3 25/32	2 5/16	5/16 & 3/8	ACPS-26-137-PP5 PB TG YZ	80000	Diagram B
	1 3/8	Polypropylene	Tan	Needle	3/8	375	3 25/32	2 5/16	3/8	ACPS-26-137-PP5 PC TG YZ	80001	Diagram C
3	1 5/16	Polypropylene	Black	Ball	5/16	270	3 25/32	2 5/8	3/8	ACPS-30-131-PP6 PC TG YZ	80002	Diagram C
	1 5/16	Polypropylene	Black	Ball	5/16	300	4 1/32	2 15/32	3/8	ACPS-30-131-PP6 PC TG YZ	80003	Diagram C

AC - Flanged Air Cargo Casters

Wheel Dia.	Tread Width (in.)	Tread Material	Tread Color	Wheel Bearing	Axle Size	Load Rating (lbs.)	Overall Height (in.)	Swivel Radius	Mounting Bolt Dia.	Swivel Caster Description	Order No.	Top Plate
2 5/8	1 3/8	Polypropylene	Tan	Needle	3/8	375	3 25/32	2 7/16	5/16 & 3/8	ACPSF-26-137-PP5 PB TG YZ	80005	Diagram B
2 3/4	1 3/8	Polypropylene	Gray	Needle	3/8	375	4 1/32	2 13/16	5/16	ACPSF-27-137-PP5 PA TG YZ	80004	Diagram A

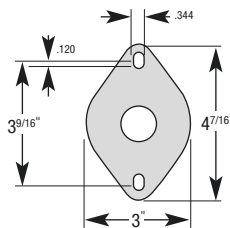

A

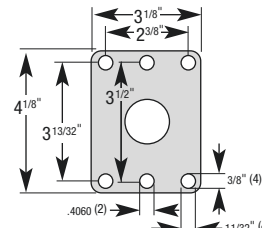

B

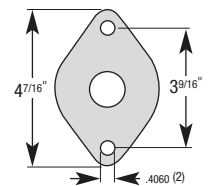

C